



5933-73

Hexagon thin slotted and castle nuts, accuracy class A.
Construction and dimensions

21.060.20
45 9500 *1

01.01.74

6 48 .
2663—89.

(. . 3).
1.

1

2

12,5 (✓)

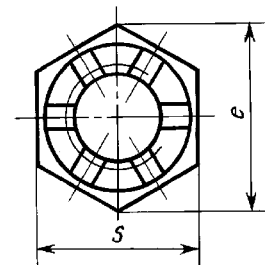
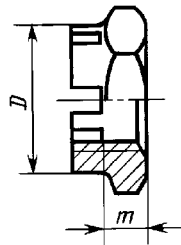
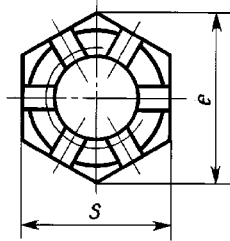
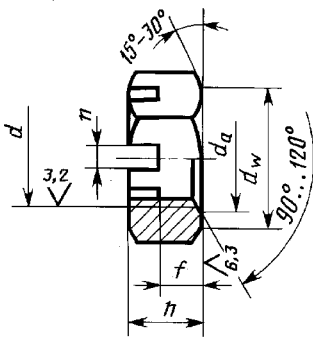

d		6	8	10	12	(14)	16	(18)	20	(22)	24	(27)	30	(33)	36	(39)	42	48
		1,0	1,25	1,5	1,75	2,0	2,0	2,5	2,5	2,5	3,0	3,0	3,5	3,5	4,0	4,0	4,5	5,0
			1,0	1,25	1,25	1,5	1,5	1,5	1,5	1,5	2,0	2,0	2,0	2,0	3,0	3,0	3,0	3,0
« » S		10	13	10	18	21	24	27	30	34	30	41	46	50	55	00	05	75
h		0	7	8	10	11	12	13	13	15	15	17	18	20	20	22	23	25
l		3,5	4,0	5,0	6,0	7,0	7,0	8,0	8,0	9,0	9,0	11	11	13	13	13	14	16
d_r		9,0	11,1	14,0	16,6	19,0	22,5	25,3	27,7	31,7	33,2	38,3	42,7	40,0	51,1	55,9	00,6	09,4
d_s		11,1	14,4	17,8	20,0	23,4	26,8	30,1	33,5	37,7	40,0	45,6	51,3	55,8	01,3	67,0	72,6	83,9
d_a		6	8	10	12	14	16	18	20	22	24	27	30	33	36	39	42	48
d_a		0,75	0,75	1,08	1,30	1,51	1,73	1,94	2,16	2,38	2,59	2,92	3,24	3,56	3,89	4,22	4,54	5,18
D					16	19	22	25	28	32	34	38	42	40	50	55	58	65
		6															8	
w		2,0	2,5	2,8	3,5	4,5			5,5			7,0			9,0			
(-) 397	!	1,616	2-20	2,5-25	3,2-32	4-36	4-40		5-45		5-50		6,3-63		6,3-71		8-80	8-90
	2				3,2-25	4-32	4-30		5-40		5-45		0,3-50		0,3-63		8-71	8-80

L

2,

2 .

3.

01.01.91,

2.

36 48

1

2

<i>d</i> ,	1000 .		<i>d</i> ,	1000 .	
	1	2		1	2
6	2,473	—	24	76,349	67,810
8	4,789	—	27	116,110	103,260
10	9,055	—	30	152,560	132,570
12	13,129	11,096	33	200,715	175,525
14	20,186	16,940	36	248,870	218,480
16	26,078	22,490	39	313,540	271,320
18	37,303	32,850	42	378,210	324,160
20	46,315	40,960	48	570,480	486,140
22	66,578	59,630			

1. (, . 5).

2

3

<i>d</i>	10	12	14	22
« » S	17	19	22	32
,	18,9	21	24,5	35,8
<i>d_w</i> ,	15,6	17,4	20,6	30,0

2. (, . 5).

. 5 5933-73

1.

2.

23.01.73 141

3.

2663—89

4032—79,

4035—79

-

« »

4.

5933-62

5.

-

--	--

397-79
1759.0-87
24705-2004

1
4
2

6.

4—93

-

, — — (4—94)

7.

1981 ., 1, 2, 3, 4, 5, 6, 1974 ., 1979 .,
6-89, 7-90) 1984 ., 1989 ., 1990 . (3—74,10—79, 2—82,1—85,